



Sewage water



Civil use



Industrial use



### PERFORMANCE RANGE

- Flow rate up to **1900 l/min** (114 m<sup>3</sup>/h)
- Head up to **31 m**

### APPLICATION LIMITS

- **10 m** maximum immersion depth (with a sufficiently long power cable)
- Maximum liquid temperature **+40 °C**
- Passage of suspended solids up to **Ø 35 mm**
- Minimum immersion depth for continuous service: **470 mm**

### CONSTRUCTION AND SAFETY STANDARDS

- **10 m** long power cable
- External float switch and control box for single-phase versions

EN 60335-1  
IEC 60335-1  
CEI 61-150

EN 60034-1  
IEC 60034-1  
CEI 2-3



### INSTALLATION AND USE

The **BC 35** series of pumps, manufactured from stainless steel and heavy gauge robust cast iron, resistant to abrasion and long-lasting, are fitted a **DOUBLE-CHANNEL** impeller and are therefore suitable for draining **dirty, sewage and reflux water, and water mixed with putrid mud**. They are suitable for installation in sewers, tunnels, excavations, canals, underground car parks, etc.

### PATENTS - TRADE MARKS - MODELS

- Patent Pending

### OPTIONS AVAILABLE ON REQUEST

- Other voltages or 60 Hz frequency

### CERTIFICATIONS

Company with management system certified DNV  
ISO 9001: QUALITY



### CHARACTERISTIC CURVES AND PERFORMANCE DATA

50 Hz n= 2900 min<sup>-1</sup>

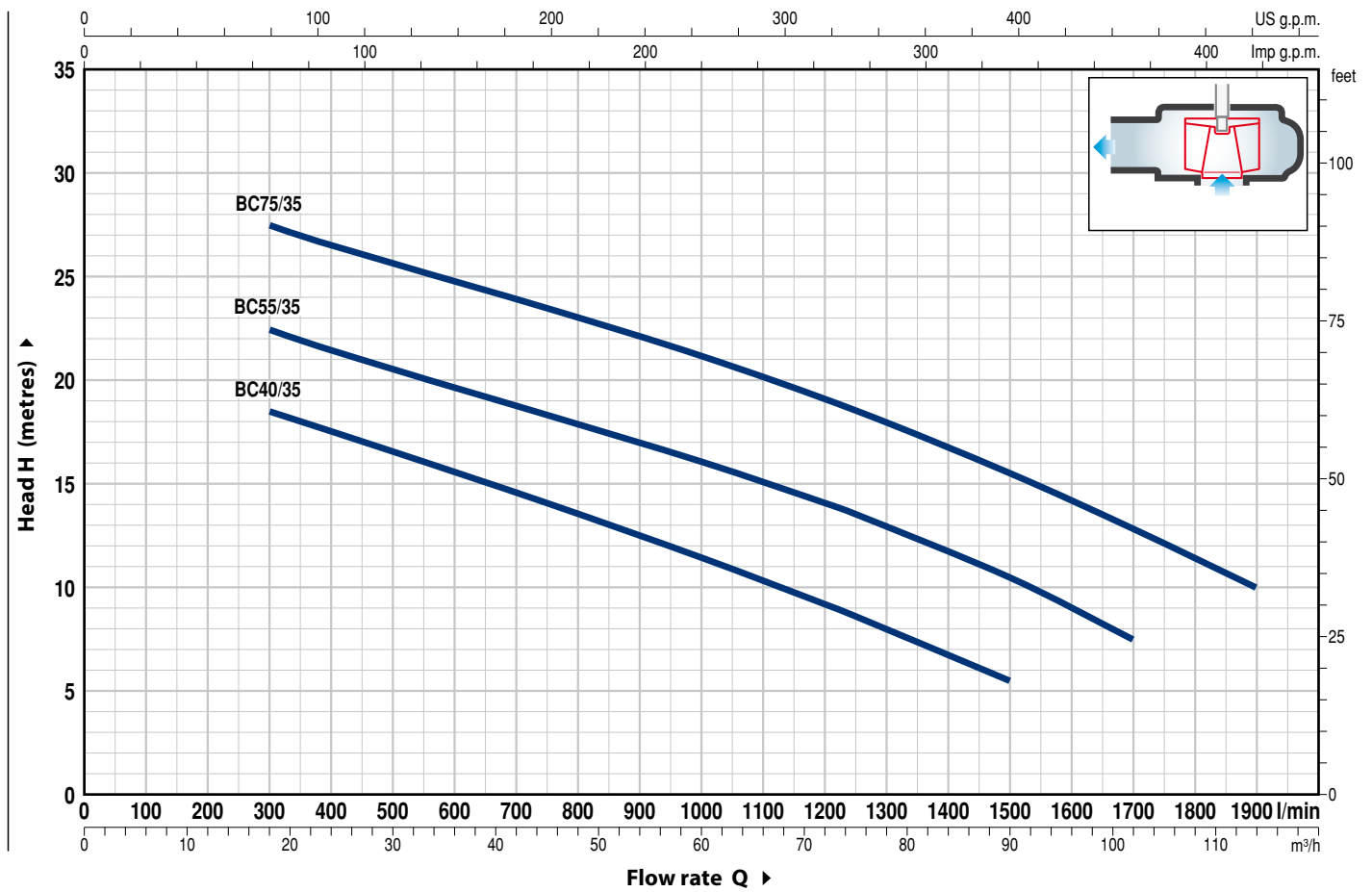

| MODEL<br>Three-phase | POWER (P <sub>2</sub> ) |     | Q        | Flow rate |      |      |      |      |      |      |      |  |
|----------------------|-------------------------|-----|----------|-----------|------|------|------|------|------|------|------|--|
|                      | kW                      | HP  |          | 0         | 18   | 36   | 54   | 72   | 90   | 102  | 114  |  |
| BC 40/35             | 3                       | 4   | H metres | 0         | 300  | 600  | 900  | 1200 | 1500 | 1700 | 1900 |  |
| BC 55/35             | 4                       | 5.5 |          | 21.4      | 18.5 | 15.5 | 12.5 | 9    | 5.5  |      |      |  |
| BC 75/35             | 5.5                     | 7.5 |          | 25.9      | 22.5 | 19.5 | 17   | 14   | 10.5 | 7.5  |      |  |
|                      |                         |     |          | 31        | 27.5 | 24.7 | 22   | 19   | 15.5 | 11.5 | 10   |  |

Q = Flow rate H = Total manometric head

Tolerance of characteristic curves in compliance with EN ISO 9906 Grade 3B.

**POS. COMPONENT CONSTRUCTION CHARACTERISTICS**

|                       |  |
|-----------------------|--|
| <b>1 PUMP BODY</b>    | Cast iron with an Epoxy Electro Coating treatment, with threaded port in compliance with ISO 228/1 |
| <b>2 IMPELLER</b>     | DOUBLE-CHANNEL type in cast iron with an Epoxy Electro Coating treatment                           |
| <b>3 MOTOR CASING</b> | Stainless steel AISI 304   |
| <b>4 CASING</b>       | Cast iron with an Epoxy Electro Coating treatment  |
| <b>5 MOTOR SHAFT</b>  | Stainless steel AISI 431   |

**6 TWO MECHANICAL SEALS SEPARATED BY AN OIL CHAMBER**

| Seal Model | Shaft Diameter | Position   | Materials       |                 |           |
|------------|----------------|------------|-----------------|-----------------|-----------|
|            |                |            | Stationary ring | Rotational ring | Elastomer |
| AR-27      | Ø 27 mm        | Motor side | Silicon carbide | Graphite        | NBR       |
| AR-25      | Ø 25 mm        | Pump side  | Silicon carbide | Silicon carbide | NBR       |

**7 BEARINGS 6306 ZZ C3 / 6304 ZZ C3**

**8 ELECTRIC MOTOR**

**BC 35:** three-phase 400 V - 50 Hz  
with thermal overload protector incorporated into the winding

- Insulation: class F
- Protection: IP X8

**9 POWER CABLE**

"H07 RN-F" type  
**Standard length 10 metres**

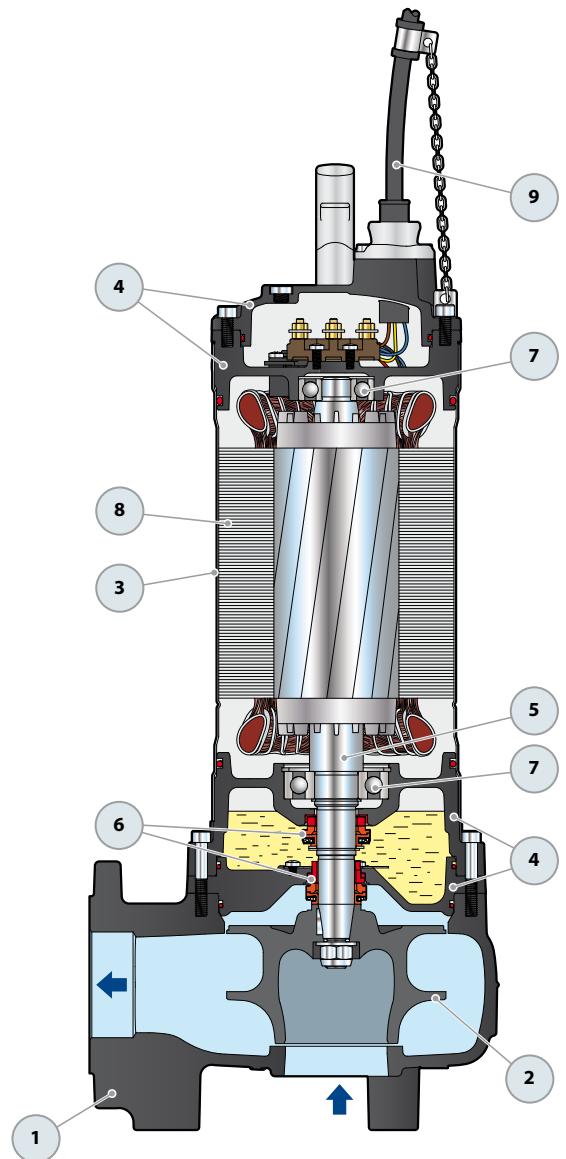

## DIMENSIONS AND WEIGHT

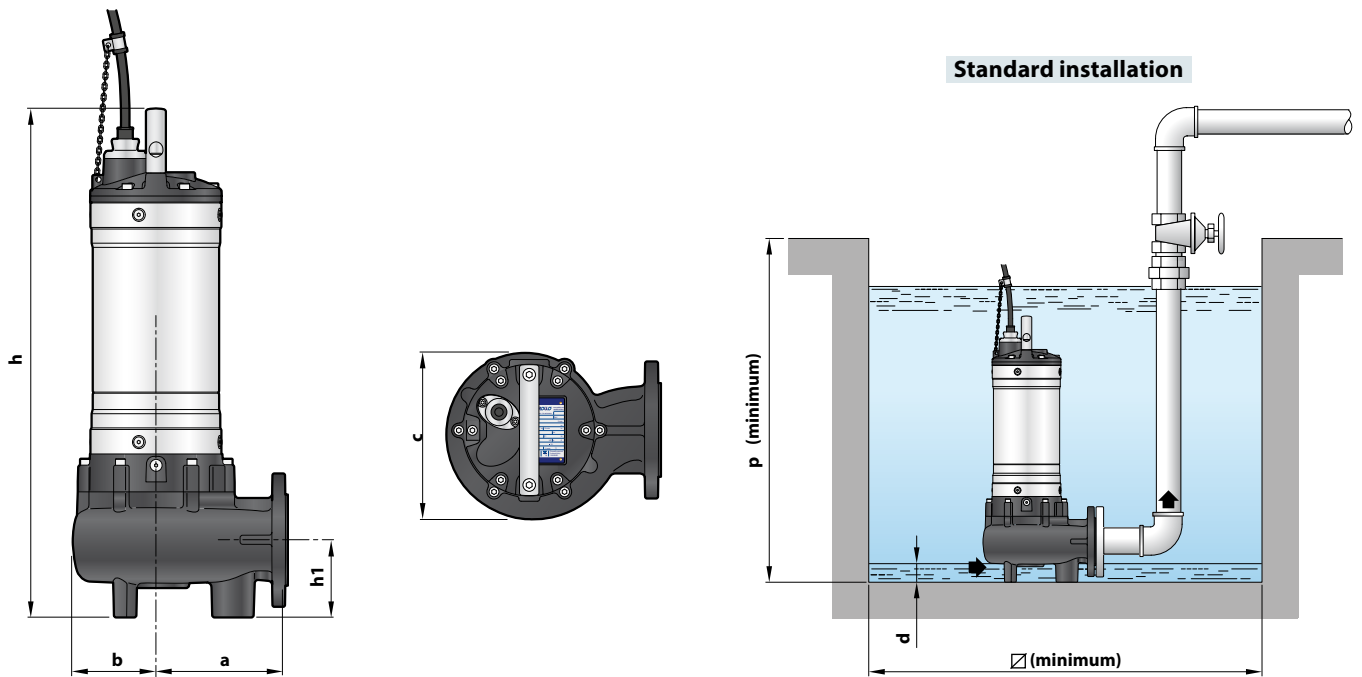

| MODEL       | Passage of solids | DIMENSIONS mm |     |     |     |     |    |     |     | 3~   |
|-------------|-------------------|---------------|-----|-----|-----|-----|----|-----|-----|------|
|             |                   | a             | b   | c   | h   | h1  | d  | p   | Ø   |      |
| Three-phase |                   |               |     |     |     |     |    |     |     |      |
| BC 40/35    | Ø 35 mm           | 170           | 113 | 225 | 595 | 100 | 40 | 800 | 500 | 56.0 |
| BC 55/35    |                   |               |     |     | 635 |     |    |     |     | 56.0 |
| BC 75/35    |                   |               |     |     | 665 |     |    |     |     | 65.0 |

## FLANGED PORT

| MODEL       | FLANGE DN | F   | K mm | D mm | HOLES |        |
|-------------|-----------|-----|------|------|-------|--------|
|             |           |     |      |      | N.    | Ø (mm) |
| Three-phase |           |     |      |      |       |        |
| BC 40/35    | 65 (PN10) | 2½" | 145  | 185  | 4     | 18     |
| BC 55/35    |           |     |      |      |       |        |
| BC 75/35    |           |     |      |      |       |        |

## ABSORPTION

| MODEL       | VOLTAGE |
|-------------|---------|
| Three-phase | 400 V   |
| BC 40/35    | 6.2 A   |
| BC 55/35    | 8.3 A   |
| BC 75/35    | 13.5 A  |

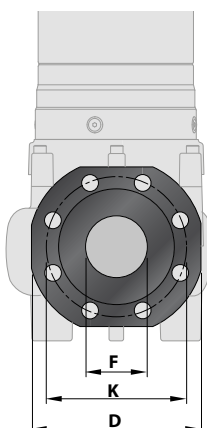

## PALLETIZATION

| MODEL       | GROUPAGE |
|-------------|----------|
| Three-phase | n. pumps |
| BC 40/35    | 12       |
| BC 55/35    | 12       |
| BC 75/35    | 12       |

# BASE PEDESTAL KIT VX40 – VX50 – VX65 – BC35

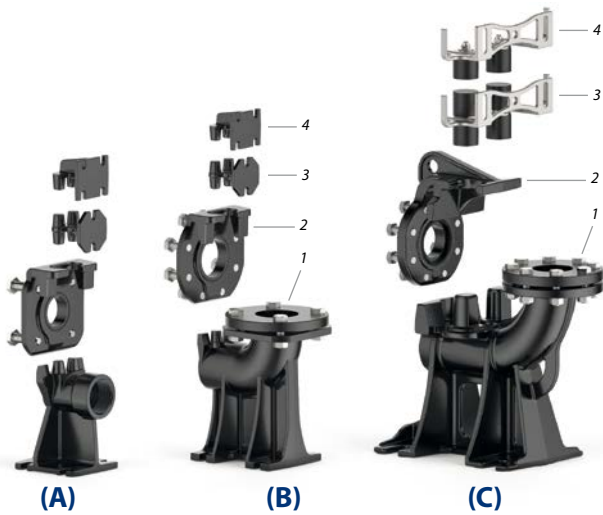

- 1 - Footing connection
- 2 - Slide guide  
(Also to be ordered separately)
- 3 - Intermediate support  
(Not included. To be ordered separately)
- 4 - Support for the guide tubes



## A) HORIZONTAL DELIVERY VERSION WITH 3/4" GUIDE TUBES

|                   |               |              |
|-------------------|---------------|--------------|
| For <b>VX /40</b> | Cod. ASSPVX40 | DN <b>2"</b> |
| For <b>VX /50</b> | Cod. ASSPVX50 | DN <b>2"</b> |

Kit consisting of:

- footing connection
- slide guide with screws and seals
- support for the guide tubes

## B) VERTICAL DELIVERY VERSION WITH 3/4" GUIDE TUBES

|                           |                 |                  |
|---------------------------|-----------------|------------------|
| For <b>VX /40</b>         | Cod. ASSPVX40V  | DN <b>2 1/2"</b> |
| For <b>VX /50</b>         | Cod. ASSPVX503V | DN <b>2 1/2"</b> |
| For <b>VX /65, BC /35</b> | Cod. ASSPVX653V | DN <b>3"</b>     |

Kit consisting of:

- footing connection complete with counterflange
- slide guide with screws and seals
- support for the guide tubes

## C) VERTICAL DELIVERY VERSION WITH 2" GUIDE TUBES

|                                   |                |              |
|-----------------------------------|----------------|--------------|
| For <b>VX /50</b>                 | Cod. ASSPVX50V | DN <b>3"</b> |
| For <b>VX /50, VX /65, BC /35</b> | Cod. ASSPVX65V | DN <b>3"</b> |

Kit consisting of:

- footing connection complete with counterflange
- slide guide with screws and seals
- support for the guide tubes

### SLIDE GUIDE (Also to be ordered separately)

|   |               |
|---|---------------|
| For <b>VX /40</b> with guide tubes $\varnothing$ 3/4"         | Cod. ASSFL011 |
| For <b>VX /50</b> with guide tubes $\varnothing$ 3/4"         | Cod. ASSFL009 |
| For <b>VX /50</b> with guide tubes $\varnothing$ 2"           | Cod. ASSFL050 |
| For <b>VX /65, BC /35</b> with guide tubes $\varnothing$ 3/4" | Cod. ASSFL010 |
| For <b>VX /65, BC /35</b> with guide tubes $\varnothing$ 2"   | Cod. ASSFL065 |

Complete with screws and seals

### INTERMEDIATE SUPPORT (To be ordered separately)

|                                    |                    |
|------------------------------------|--------------------|
| For guide tubes $\varnothing$ 3/4" | Cod. 859SV340INTFA |
| For guide tubes $\varnothing$ 2"   | Cod. 859SV349INTFA |

### TUBO GUIDA (AISI 304 stainless steel)

|                               |                 |
|-------------------------------|-----------------|
| Guide tube $\varnothing$ 3/4" | Cod. 54SARTG005 |
| Guide tube $\varnothing$ 2"   | Cod. 54SARTG006 |

**In order to ensure stability, insert the intermediate support:**

- every 2 metres with 3/4" guide tubes (compulsory)
- every 3 metres with 2" guide tubes (recommended)

Maximum length of the tube plank: 6 metres

## STANDARD INSTALLATION

1. Pump
2. Footing connection
3. Guide tubes
4. Support for the guide tubes
5. Lifting chain
6. Control box
7. Alarm float switch
8. Starting float switch
9. Stop float switch
10. Non-return valve

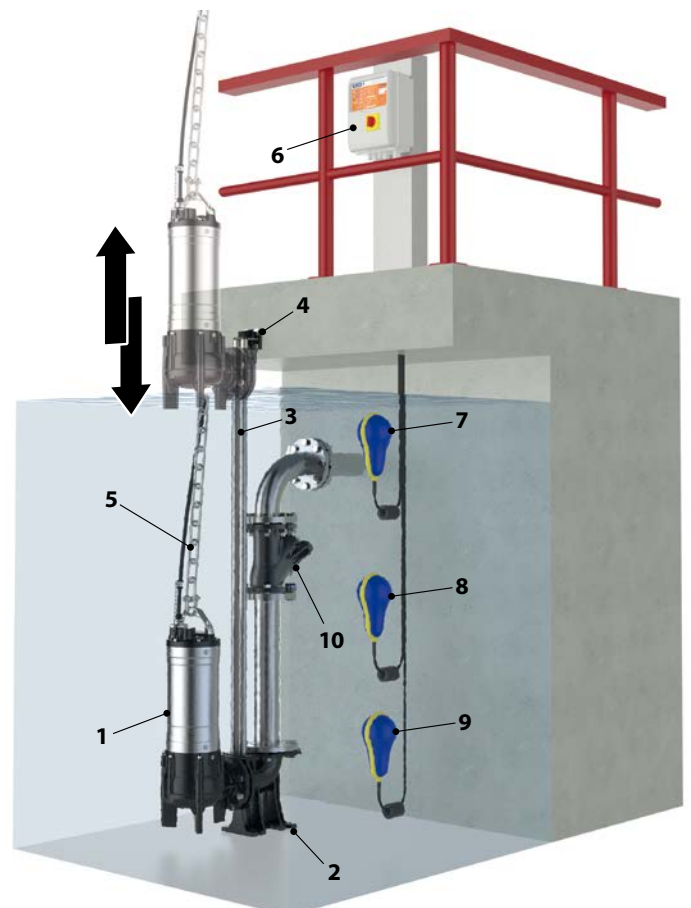

### DIMENSIONS (Horizontal delivery version)

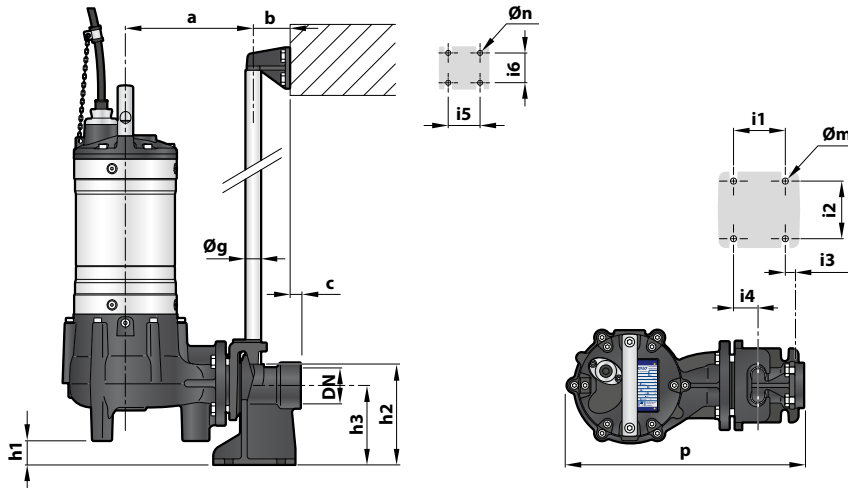

| MODEL       | Passage of solids<br>mm | PORT<br>DN | DIMENSIONS mm |    |    |     |    |     |     |    |    |    |    |    |    |    |    |    |
|-------------|-------------------------|------------|---------------|----|----|-----|----|-----|-----|----|----|----|----|----|----|----|----|----|
|             |                         |            | a             | b  | c  | p   | h1 | h2  | h3  | i1 | i2 | i3 | i4 | i5 | i6 | Øg | Øm | Øn |
| Three-phase | Ø 40                    | 2"         | 214           | 61 | 17 | 400 | 42 | 165 | 130 | 85 | 94 | 16 | 40 | 50 | 48 | ¾" | 12 | 11 |
| VX /40      | Ø 50                    |            |               |    |    |     | 30 |     |     |    |    |    |    |    |    |    |    |    |
| VX /50      | Ø 50                    |            |               |    |    |     |    |     |     |    |    |    |    |    |    |    |    |    |

### DIMENSIONS (Vertical delivery version)

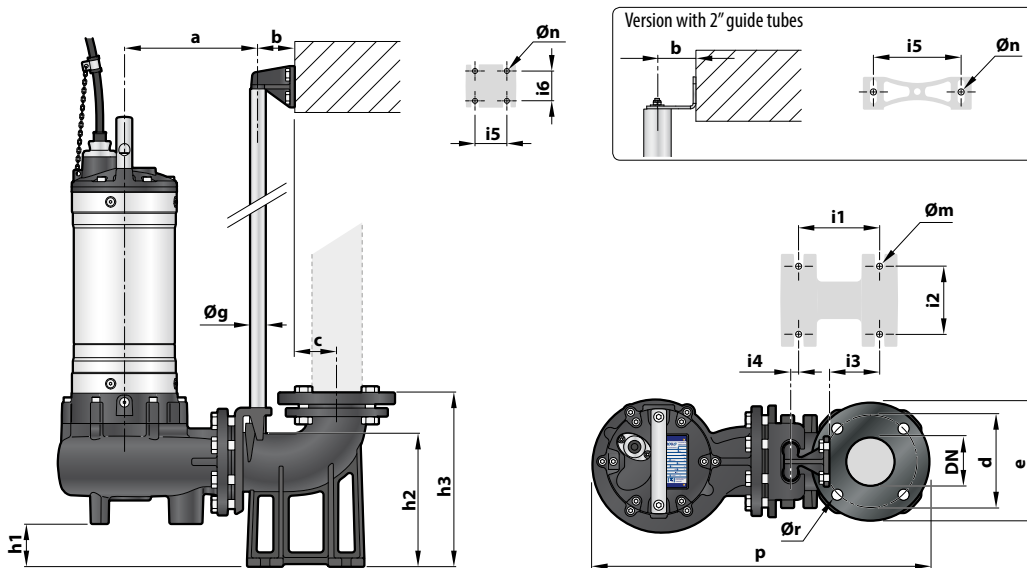

#### Version with ¾" guide tubes

| MODEL       | Passage of solids<br>mm | PORT<br>DN | DIMENSIONS mm |    |    |     |     |     |    |     |     |     |     |    |    |    |    |    |    |    |    |
|-------------|-------------------------|------------|---------------|----|----|-----|-----|-----|----|-----|-----|-----|-----|----|----|----|----|----|----|----|----|
|             |                         |            | a             | b  | c  | d   | e   | p   | h1 | h2  | h3  | i1  | i2  | i3 | i4 | i5 | i6 | Øg | Øm | Øn | Ør |
| Three-phase | Ø 40                    | 2½"        | 211           | 61 | 52 | 125 | 165 | 506 | 40 | 164 | 216 | 120 | 72  | 62 | 3  | 50 | 48 | ¾" | 14 | 11 | 18 |
| VX /40      | Ø 50                    |            |               |    |    |     |     | 28  |    |     |     |     |     |    |    |    |    |    |    |    |    |
| VX /50      | Ø 50                    |            |               |    |    |     |     |     |    |     |     |     |     |    |    |    |    |    |    |    |    |
| VX /65      | Ø 65                    | 3"         | 213           | 61 | 69 | 150 | 190 | 537 | 48 | 216 | 280 | 130 | 112 | 84 | 15 |    |    |    |    |    |    |
| BC /35      | Ø 35                    |            |               |    |    |     |     | 550 | 69 |     |     |     |     |    |    |    |    |    |    |    |    |

#### Version with 2" guide tubes

| MODEL       | Passage of solids<br>mm | PORT<br>DN | DIMENSIONS mm |    |    |     |     |     |     |     |     |     |     |    |    |     |    |    |    |      |    |
|-------------|-------------------------|------------|---------------|----|----|-----|-----|-----|-----|-----|-----|-----|-----|----|----|-----|----|----|----|------|----|
|             |                         |            | a             | b  | c  | d   | e   | p   | h1  | h2  | h3  | i1  | i2  | i3 | i4 | i5  | i6 | Øg | Øm | Øn   | Ør |
| Three-phase | Ø 50                    | 3"         | 319           | 86 | 95 | 160 | 200 | 706 | 107 | 264 | 392 | 250 | 150 | 34 | -  | 186 | -  | 2" | 22 | 13.5 | 18 |
| VX /50      | Ø 65                    |            |               |    |    |     |     | 697 | 86  |     |     |     |     |    |    |     |    |    |    |      |    |
| VX /65      | Ø 65                    |            |               |    |    |     |     | 710 | 107 |     |     |     |     |    |    |     |    |    |    |      |    |
| BC /35      | Ø 35                    |            |               |    |    |     |     |     |     |     |     |     |     |    |    |     |    |    |    |      |    |